

ROBOTIC WELDING CELLS

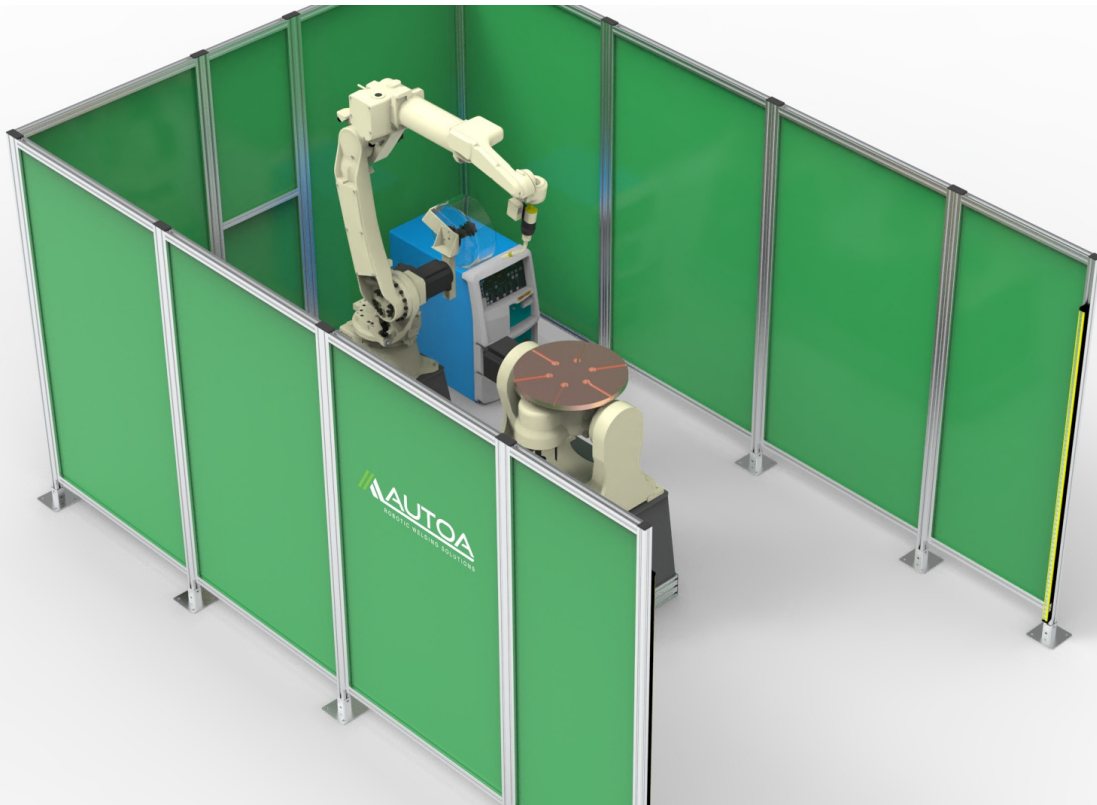

AUTOA
ENGINEERING PRODUCTIVITY WITH ROBOTICS

T-500 CELL



If you're looking for a robotic welding solution to address labour shortages and quality concerns, the Autoa T-500 Cell is the perfect first step into robotic welding. Designed as a cost-effective option for businesses, this workcell features all of the pre-engineered safety and efficiency of our welding systems.

With its single robot and servo turntilt positioner, the T-500 robot welding cell not only ensures a quick payback on your investment with its advanced robotic technology and precision welding capabilities, but also guarantees fast cycle times while reliably producing high-quality parts. By adopting automation into your current workflow, you can minimise waste while increasing efficiency and quality, which helps with lean manufacturing. With the Autoa T-500 Cell, you can achieve your production goals while streamlining your processes and staying competitive in your industry.

Welding Jig Dimensions	800 x 1000mm
Positioner Capacity	500kg (1000kg option available)
Power Supply Requirements	32A 3ph 400V + Neutral
Dimensions	4054 x 2755 x 2005 mm



T-500 CELL DIMENSIONS

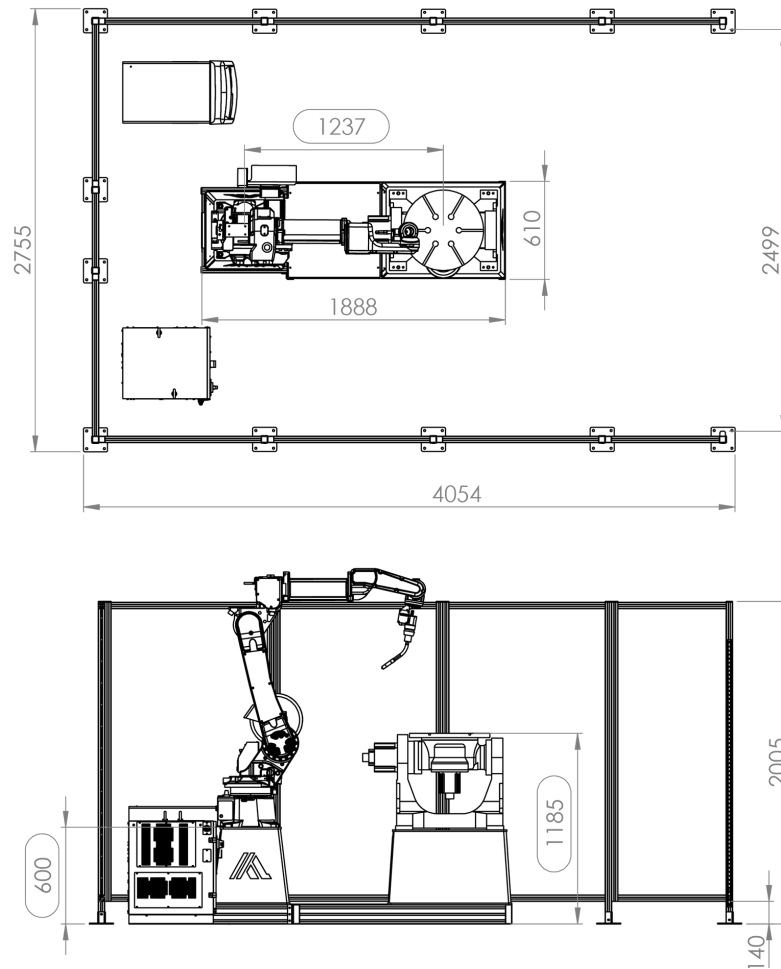

FEATURES OF THE T-500 WELDING CELL:

Work Cell Design:

- Flexible single workstation arc welding workcell.
- Compact footprint in Autoa cell standard range.

Equipment Included:

- OTC Daihen or Yaskawa model through-arm welding robot with 2000mm reach.
- OTC Welbee P502L 500amp low spatter power source standard. Other power source brands available on request.
- 350amp air cooled welding torch and wire feeder standard. 500amp water cooled welding torch available on request.
- Dual axis turn-tilt positioner for flexible part positioning.
- Enhanced safety guarding that is fully compliant with latest robot safety standard (ISO 10218-1). Optional arc guards provide additional arc protection for robot operators.

Workpiece Capacity:

- The turn-tilt servo positioner is designed for welding complex and compact assemblies with multi pass welds. Common products are; excavator attachments, quickhitch assemblies and hard facing.

U-2800 CELL

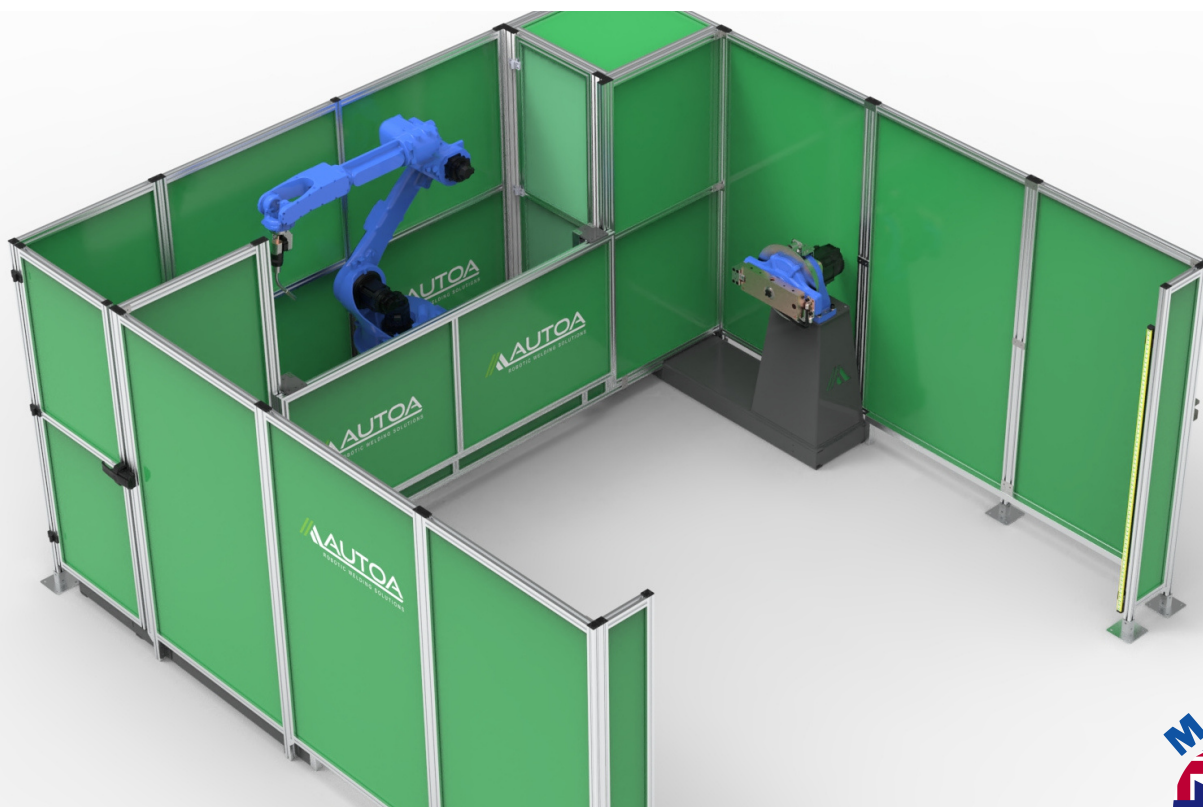

The Autoa U-2800 robot welding cell is a compact and highly productive workcell designed for general fabricators who need to weld small to medium-sized parts. This welding system features a single workstation with single positioners (head and tail stock), with a 1000kg capacity.

With its advanced robotic technology, the Autoa U-2800 cell increases productivity quickly and easily, making it an ideal solution for large batch component manufacturing that are labour-intensive or manufacturers with high production requirements. Whether you're looking to improve your welding efficiency, minimise errors, or reduce labour costs, the U-2800 is a reliable and cost-effective solution. With its large capacity, this welding cell can handle even the most demanding welding tasks, ensuring that you can meet your production goals and maintain a competitive edge in your industry.

Welding Jig Dimensions	1600 x 2800 mm
Positioner Capacity	1000kg
Power Supply Requirements	32A 3ph 400V + Neutral
Dimensions	4093 x 3982 x 2005 mm



U-2800 CELL DIMENSIONS

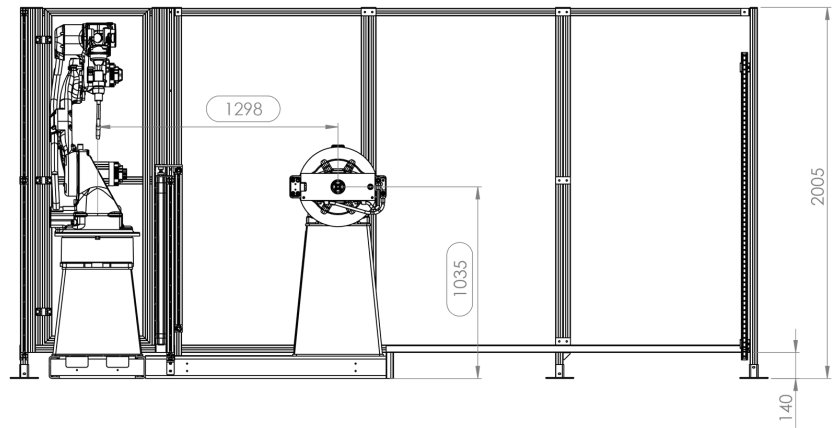
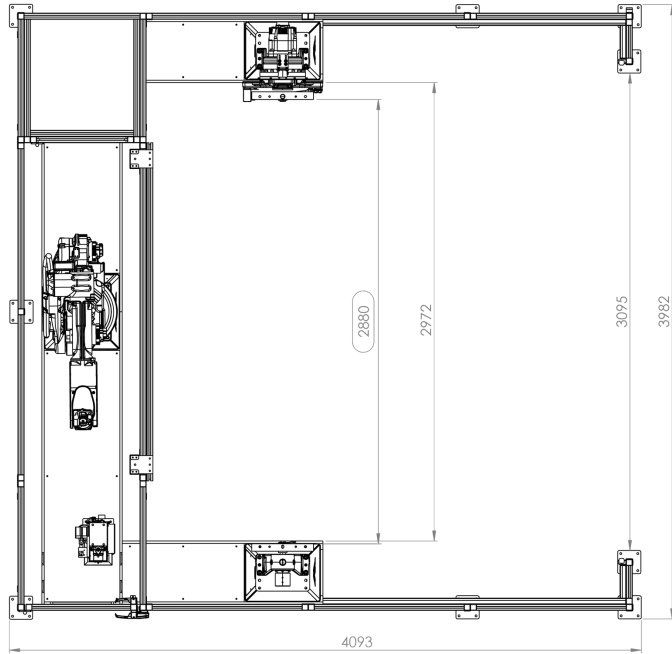

FEATURES OF THE U-2800 WELDING CELL:

Work Cell Design:

- Single workstation with single positioner arc welding workcell.
- Robot controller and welding power source in external closure away from welding contaminants.
- Clean floor design with all cables and floor fixings protected from weld spatter.

Equipment Included:

- OTC Daihen or Yaskawa model through-arm welding robot with 2000mm reach.
- OTC Welbee P502L 500amp low spatter power source standard. Other power source brands available on request.
- 350amp air cooled welding torch and wire feeder standard. 500amp water cooled welding torch available on request.
- Single axis positioner for rotation of parts in welding process.
- Enhanced safety guarding that is fully compliant with latest robot safety standard (ISO 10218-1). Optional arc guards provide additional arc protection for robot operators.

Workpiece Capacity:

- The single workstation is ideal for wider parts up to 2800mm long and that need to be repositioned during welding. The U-2800 is also available with a fixed table for parts that do not require rotation in welding process.

Y-1600 CELL



The Autoa Y-1600 robot welding cell is a dual-workstation system that features positioners (head and tailstock), allowing manufacturers to process different parts in each workstation or double up production on the same part. With its two-station setup, the Y-1600 enables quick changeovers for a higher mix of part variations, making it a cost-effective solution for manufacturers who need to weld multiple parts.

This system is mechanically robust and is well-suited for the manufacturing of small to medium-sized repetitive products, such as those found in the agriculture and furniture industries. With the Autoa Y-1600 dual-station design, manufacturers can maximise uptime for higher volume runs, improving both speed and quality. This compact workcell can occupy a typical single-station space, making it an ideal solution for manufacturers with limited floor space. By adopting the Y-1600, you can integrate robotics into your welding processes and achieve greater productivity, efficiency, and quality in your manufacturing operations.

Welding Jig Dimensions	1600 x 850 mm
Positioner Capacity	500kg (1000kg option available)
Power Supply Requirements	32A 3ph 400V + Neutral
Dimensions	3980 x 5640 x 2005 mm



Y-1600 CELL DIMENSIONS

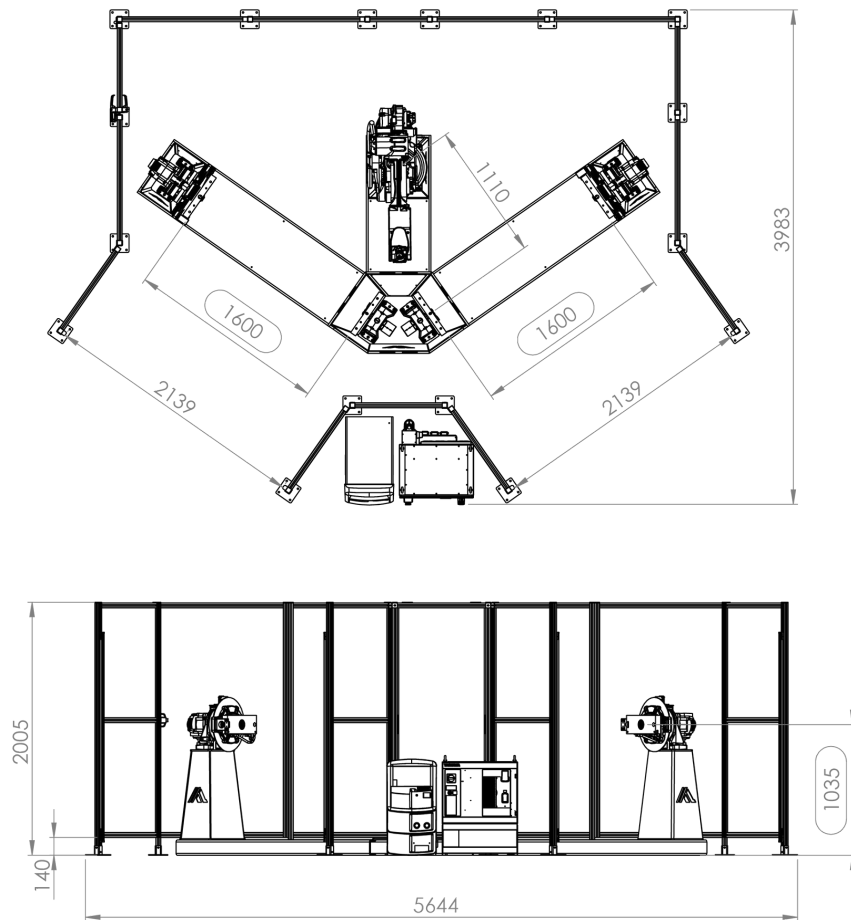

FEATURES OF THE Y-1600 WELDING CELL:

Work Cell Design:

- Ergonomic cell design for operators to move from station to station with less walking.
- Two station workcell that fits within the space of a typical single-station workcell.

Equipment Included:

- OTC Daihen or Yaskawa model through-arm welding robot with 2000mm reach.
- OTC Welbee P502L 500amp low spatter power source standard. Other power source brands available on request.
- 350amp air cooled welding torch and wire feeder standard. 500amp water cooled welding torch available on request.
- Two Single axis positioners for rotation of parts in welding process.
- Enhanced safety guarding that is fully compliant with latest robot safety standard (ISO 10218-1). Optional arc guards provide additional arc protection for robot operators.

Workpiece Capacity:

- Each workstation is ideal for parts up to 1600mm that need to be repositioned during processing. Also available with a tooling table on either side.

H-2800 CELL

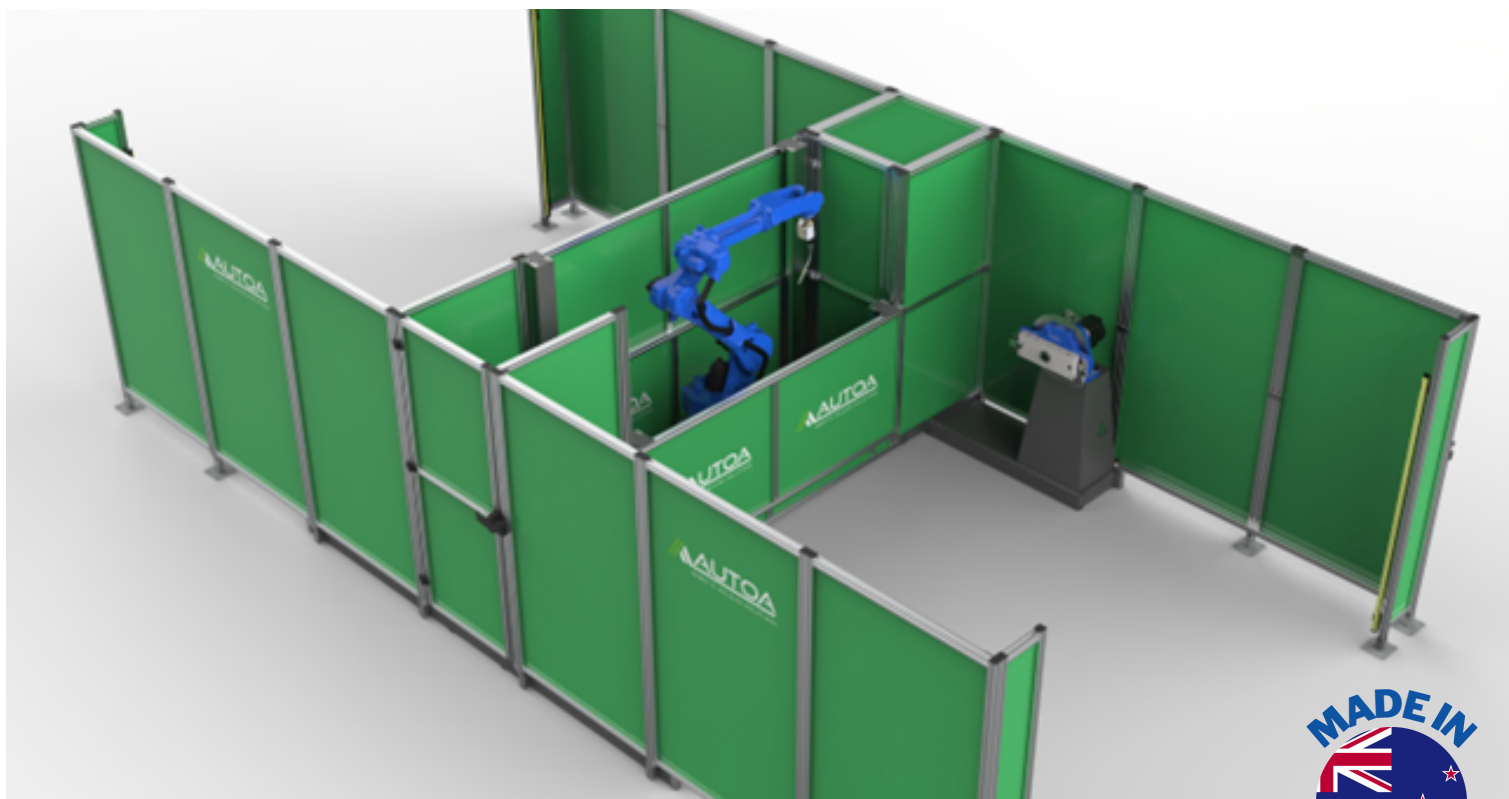

The Autoa H-2800 robot welding cell is the ideal heavy-duty solution for manufacturers who require high-volume welding of large, heavy parts. This workcell features dual servo-controlled positioners (head and tailstock) and H-frame design enables operators to prepare work on station one while the robot welds on station two, maximising productivity.

Our H-2800 robotic workcell delivers maximum power and performance on a whole new scale, making it the perfect choice for heavy-deposition welding and large parts fabrication. Despite its powerful performance, the Autoa H-2800 does not sacrifice safety features and ease of integration that characterise our smaller workcells. With its advanced robotic technology and precision welding capabilities, the H-2800 can handle even the most challenging welding tasks with ease. By integrating the H-2800 into your manufacturing processes, you can achieve maximum productivity, efficiency, and quality while ensuring the safety of your workers and staying competitive in your industry.

Welding Jig Dimensions	1600 x 2800 mm
Positioner Capacity	1000kg each side
Power Supply Requirements	32A 3ph 400V + Neutral
Dimensions	3980 x 7250 x 2005 mm



H-2800 CELL DIMENSIONS

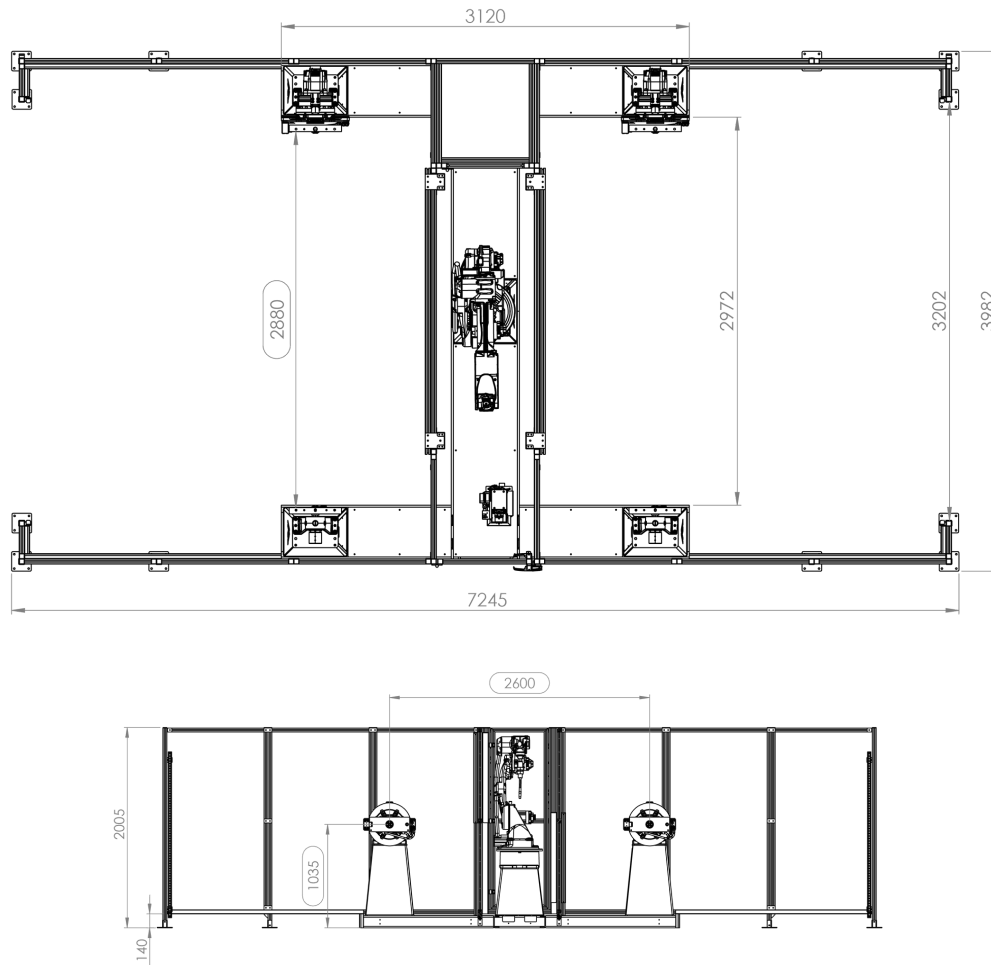

FEATURES OF THE H-2800 WELDING CELL:

Work Cell Design:

- Two-station configuration allows for welding on one station while loading/unloading on the other, improving production efficiency.
- Functional Safety Unit (FSU) ensures robot operation in areas clear of operator presence.

Equipment Included:

- OTC Daihen or Yaskawa model through-arm welding robot with 2000mm reach.
- OTC Welbee P502L 500amp low spatter power source standard. Other power source brands available on request.
- 350amp air cooled welding torch and wire feeder standard. 500amp water cooled welding torch available on request.
- Two Single axis 1000kg positioners for rotation of parts in the welding process.
- Enhanced safety guarding that is fully compliant with latest robot safety standard (ISO 10218-1). Optional arc guards provide additional arc protection for robot operators.

Workpiece Capacity:

- Each workstation is ideal for wider parts up to 2800mm long and that need to be repositioned during welding. The H-2800 is also available with a fixed table for parts that do not require rotation in welding process.

S-4800 CELL

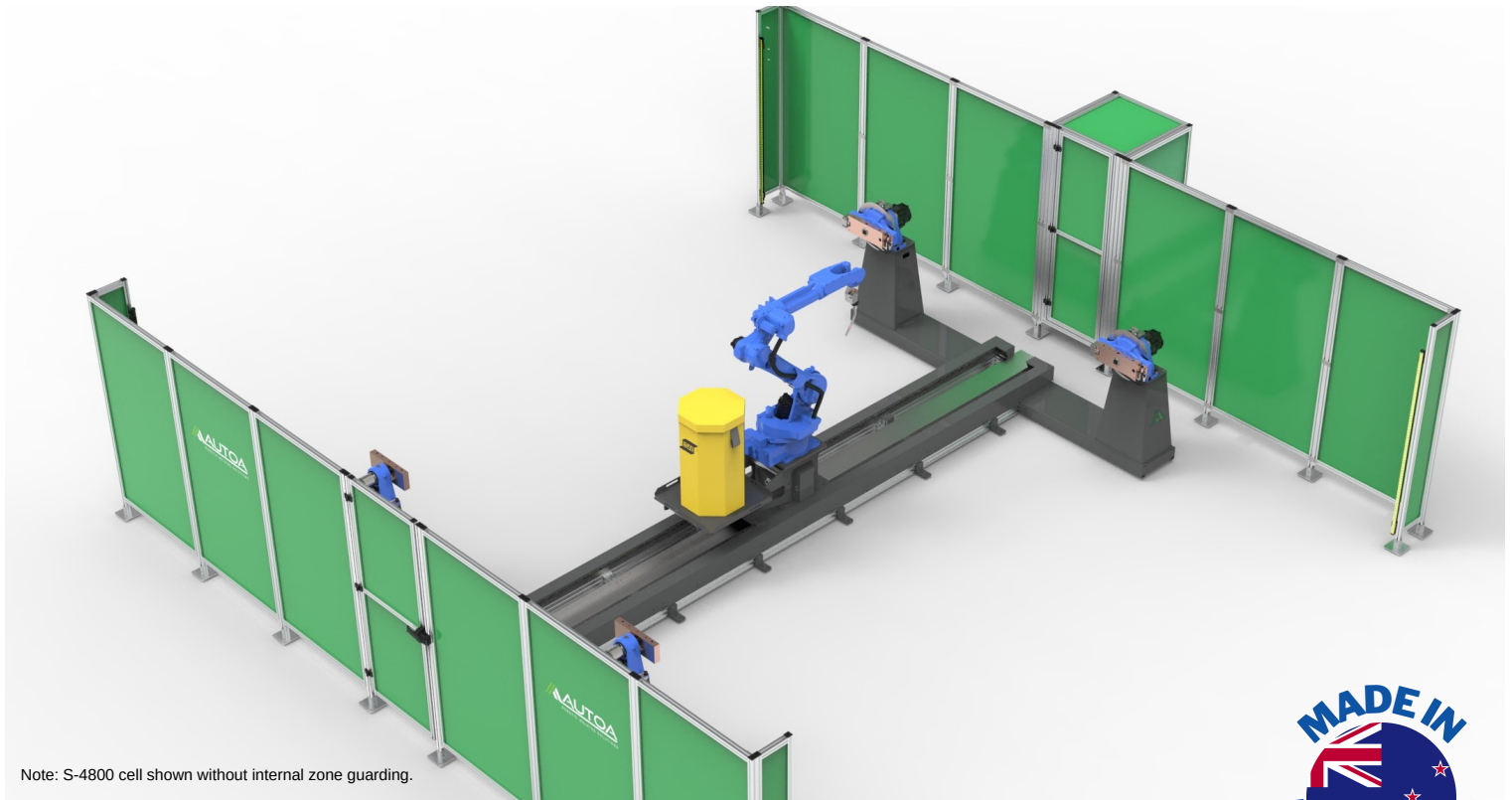

The Autoa S-4800 robot welding cell is a highly efficient workcell designed for maximum throughput. Featuring a robot slider track, which serves as an additional axis in the dual-workstation cell, the S-4800 enables coordinated motion across eight axis; between the robot and positioned part, ensuring speed and efficiency.

With its H-cell design and dual servo-controlled positioners in the two workstations, the S-4800 maximises productivity and quality, making it the perfect solution for medium to larger parts manufacturing in demanding production environments. This workcell opens up a world of welding possibilities, enabling you to grow your productivity without expanding your space. Easily scale from a two-workstation cell to four workstations, with multiple configurations available to help you adapt to changing demands. The Autoa S-4800 workcell is ideal for labour-intensive jobs involving large parts or heavy deposition, providing you with precise welding and advanced robotic capabilities to streamline your production processes and maximise efficiency.

Welding Jig Dimensions	1600 x 4800 mm (larger options available)
Positioner Capacity	1000kg each side (other capacity's available)
Power Supply Requirements	32A 3ph 400V + Neutral
Dimensions	8000 x 7250 x 2005 mm



S-4800 CELL DIMENSIONS

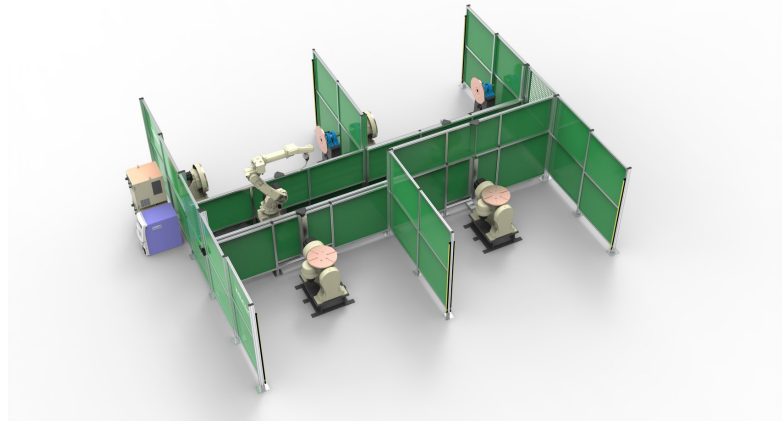
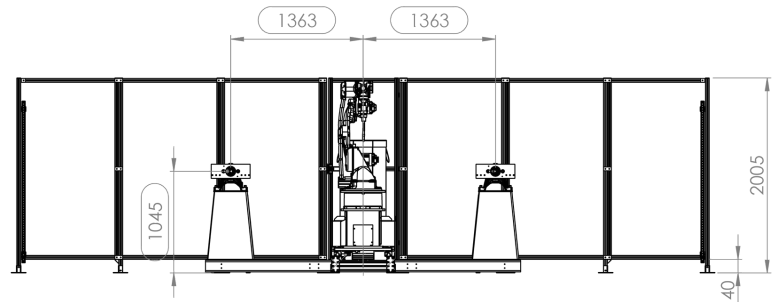
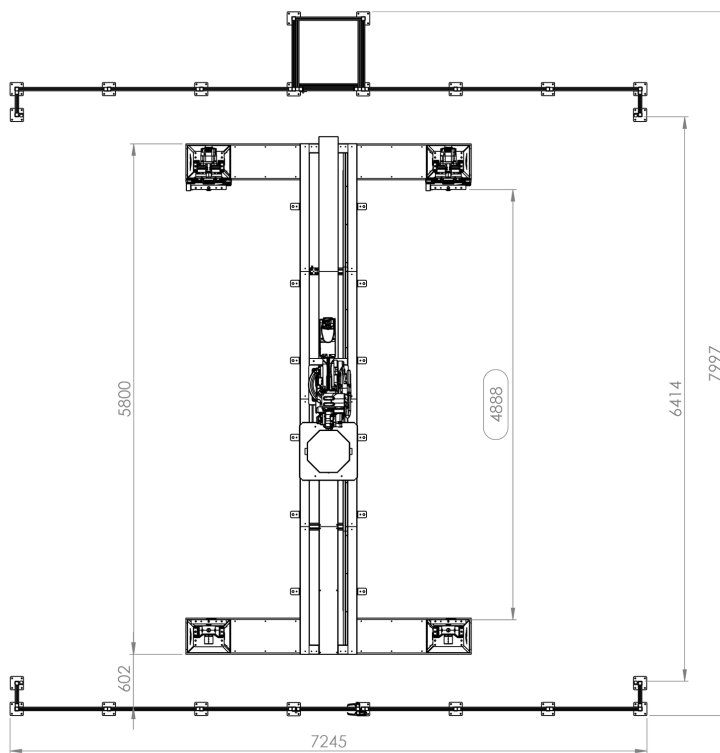

Example above of alternative configuration.

FEATURES OF THE S-4800 WELDING CELL:

Work Cell Design:

- Customisable workcell with other dimensions and configurations available e.g. options for rotation of longer parts and larger diameter parts.
- Intended for chassis type parts and design offers overhead crane access.
- Functional Safety Unit (FSU) ensures robot operation in areas clear of operator presence.

Equipment Included:

- OTC Daihen or Yaskawa model through-arm welding robot with 3000mm reach.
- OTC Welbee P502L 500amp low spatter power source standard. Other power source brands available on request.
- 500amp water cooled welding torch and wire feeder standard. 350amp air cooled welding torch available on request.
- Two Single axis 1000kg positioners for rotation of parts in the welding process.
- Enhanced safety guarding that is fully compliant with latest robot safety standard (ISO 10218-1). Optional arc guards provide additional arc protection for robot operators.

Workpiece Capacity:

- Each workstation is ideal for longer parts up to 8000mm that need to be repositioned during welding. The S-4800 is also available with fixed table options for parts that do not require rotation in welding process.



ENGINEERING PRODUCTIVITY WITH ROBOTICS



Autoa: Engineering Productivity with Robotics

Emerging from the innovative legacy of Autoline Automation, Autoa is a forward-thinking brand with a laser focus on "engineering productivity with robotics." With over 35 years of industry experience, Autoline has consistently pushed the boundaries of technology, carving a reputation for groundbreaking solutions in automation and robotics.

Founded in New Zealand, Autoa is dedicated to meeting the distinctive manufacturing requirements of the Australasian market. Our state-of-the-art Autoa Cells are designed and built in New Zealand, ensuring the highest quality and performance.

In a strategic move to offer customers maximum flexibility and compatibility, Autoa collaborates with renowned Japanese robotics manufacturers OTC Daihen and Yaskawa. Our modular approach allows clients to integrate any brand of welding power source seamlessly, making Autoa Cells a versatile solution for a wide range of applications.

Underpinned by Autoline's rich history of innovation, Autoa is committed to revolutionising the engineering productivity landscape through advanced robotics and relentless dedication to customer satisfaction.

Autoa Cells qualify for lifetime discounted robot training at ANZRA Robotics Academy.



YASKAWA



Manufactured by: Autoline

